

Adjusting A Drawer

1.) Leveling the drawer front

First remove the drawers. Extend drawer and squeeze tabs on front locking device to release, and the drawer will remove easily. (See Fig. 1)

The plastic levers that slide forward and back adjust the levelness of the drawer front. Slide the lever forward (toward the drawer front) to lower that side, slide the lever back to raise that side. (Fig. 2). If still not level, locate the screw attaching the drawer glide to the cabinet frame on the side of the drawer that needs to be raised to achieve level. Using a phillips head screwdriver, loosen the screw, raise the drawer glide to the desired height, and retighten the screw. (Fig. 3).



Fig. 1

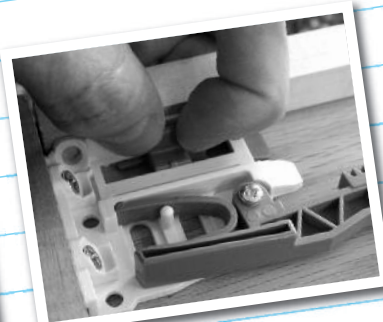

Fig. 2



Fig. 3



2.) Drawer doesn't close completely

This is normally caused by an easy to fix problem. If you haven't already removed the drawer box, please do so now. Once removed, check the small piston on the glide. If this piston is not seated in the housing bracket securely, or is too far forward or back, that may be the cause of the problem (Fig. 4).

Another possibility is that the screw towards the back of the glide has worked itself loose somehow. It could be sticking out far enough for the drawer to catch on when trying to close. Simply tighten this screw with a phillips screwdriver (Fig. 5).



Fig. 5

Proper seating of soft-close piston

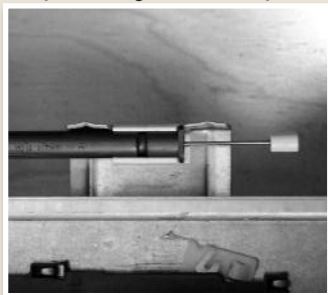

too far forward



too far back



Fig. 4

If the drawer still won't close completely, it's possible the drawer box simply needs to be resealed. Locate the plastic "teeth" on the underside of the drawer box and also on the glide mounted to the cabinet. If the drawer box is not seated all the way into the teeth then the drawer stops short. There are metal tabs on the back of the glide that will slip into the back of the drawer box (there are holes drilled out for them) If all these things appear to be correct, call dealer services at 319-268-2590 to replace the pistons or the entire glide.